



DISCLAIMER
 The United States Government furnishes this information for your information only. It is not intended for use in any way that may constitute an endorsement, approval, or implied warranty of the accuracy, completeness, reliability, usability, or timeliness of the information. The user is responsible for the results of any application of the information. The user is responsible for the results of any application of the information. The user is responsible for the results of any application of the information.

Prepared Under the Direction of JOHN C. MORROW LT COLONEL, C.E. DISTRICT ENGINEER	Surveyed By: _____	Chart Date: Jun 07, 2019
Submitted: Hydro Survey Team Leader	Plotted By: PDT	Designed by: _____
Recommended: Chief, Hydro Survey Section	Checked By: PDT	Drawn by: _____
Approved: Chief, Construction Branch		PDT

CALIFORNIA
SAN MATEO COUNTY
REWOOD CITY
CONDITION SURVEY
24-28 MAY 2019

Sheet Reference Number
1 of 4

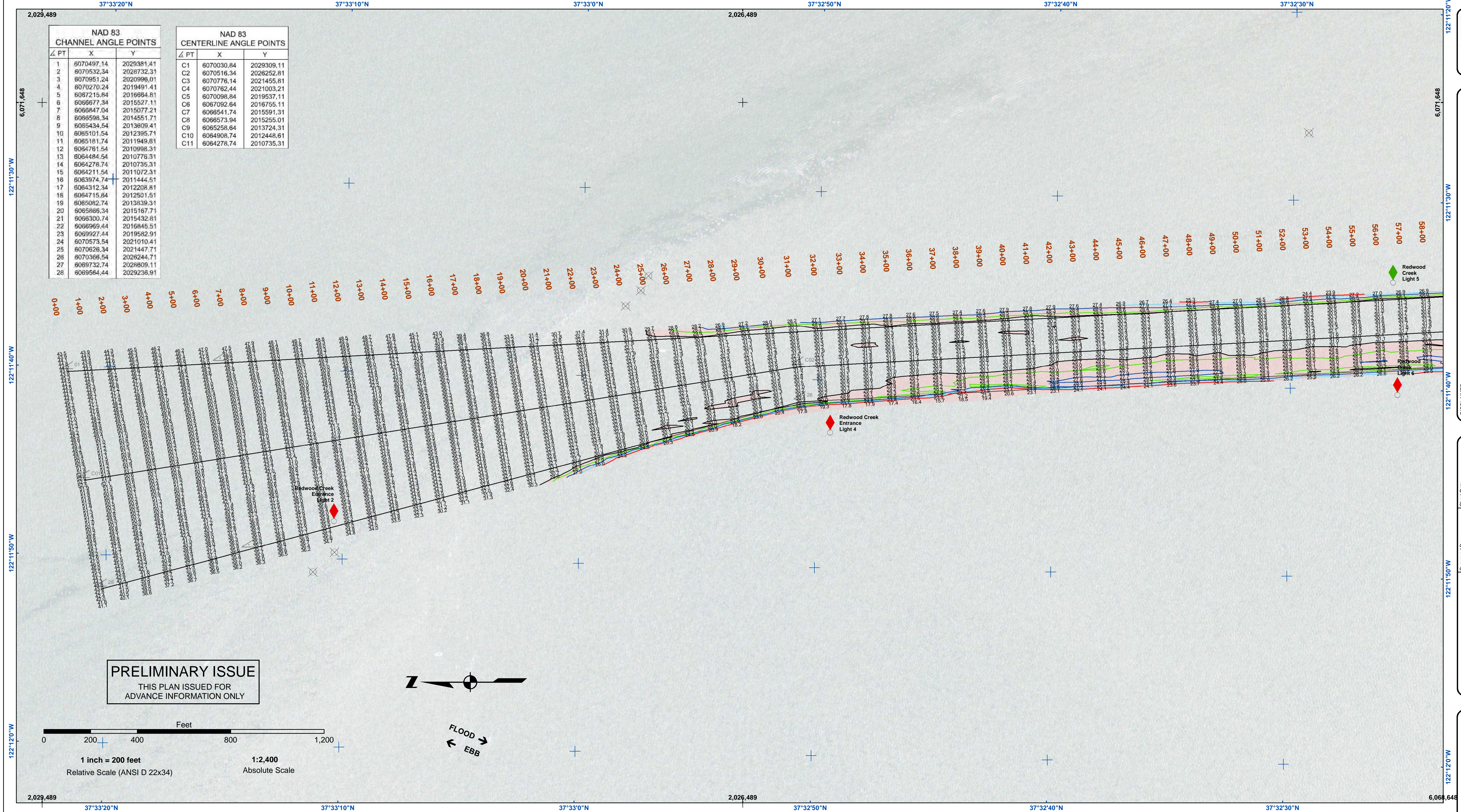

NAD 83 CHANNEL ANGLE POINTS		
PT	X	Y
1	6070497.14	2029381.41
2	6070532.34	2028732.31
3	6070951.24	2020996.01
4	6070270.24	2019491.41
5	6067215.84	2018684.81
6	6068677.34	2015527.11
7	6068847.04	2015077.21
8	6068598.34	2014551.71
9	6065434.54	2013609.41
10	6065101.54	2012395.71
11	6065181.74	2011949.61
12	6064781.54	2010998.31
13	6064484.54	2010776.31
14	6064278.74	2010735.31
15	6064211.54	2011072.31
16	6063974.74	2011444.51
17	6064312.34	2012208.81
18	6064715.84	2012501.51
19	6065082.74	2013839.31
20	6065886.34	2015167.71
21	6066300.74	2015432.81
22	6066969.44	2016845.51
23	6069927.44	2019582.91
24	6070573.54	2021010.41
25	6070626.34	2021447.71
26	6070366.54	2028244.71
27	6069732.74	2028609.11
28	6069564.44	2029236.91

NAD 83 CENTERLINE ANGLE POINTS		
PT	X	Y
C1	6070030.84	2029309.11
C2	6070516.34	2026252.81
C3	6070776.14	2021455.81
C4	6070762.44	2021003.21
C5	6070098.84	2019537.11
C6	6067092.64	2018755.11
C7	6066541.74	2015591.31
C8	6066573.94	2015255.01
C9	6065258.84	2013724.31
C10	6064908.74	2012448.81
C11	6064278.74	2010735.31

PRELIMINARY ISSUE
 THIS PLAN ISSUED FOR
 ADVANCE INFORMATION ONLY



FLOOD →
 ← EBB

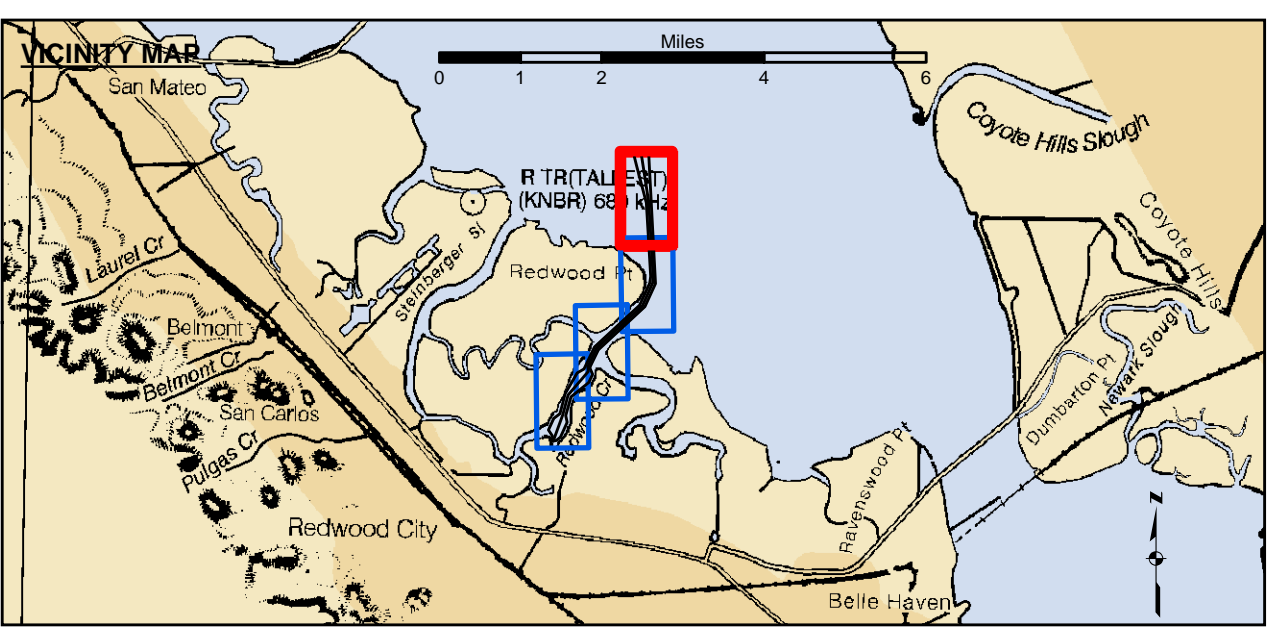
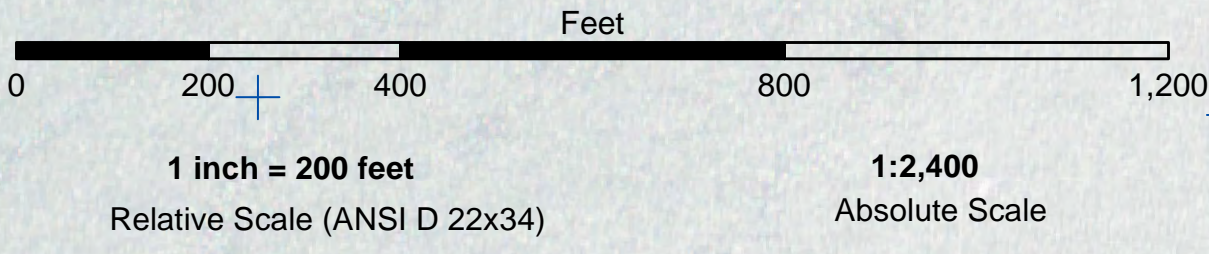

Federal Navigation Channel	Beacon, General	Contours
Shoaling Area	Obstruction Point	-30
Material Placement Area	Navigation Buoy	-29
Anchorage Area	Navigation Buoy	-28
Wreck Area	Shoalest Sounding*	-27
Submerged Wreck		-26
Angle Point		

NOTES:
 DRAWING NOT TO BE USED FOR NAVIGATION. ONLY CHANNEL CONDITION AT DATE OF SURVEY.
 THE LOCATION OF ALL NAVIGATION AIDS ARE BASED ON INFORMATION PROVIDED BY THE U.S. COAST GUARD. BUOY LOCATIONS REPRESENT THE POSITION OF THE SINKER ONLY.
 INFORMATION DEPICTED ON THIS MAP REPRESENTS THE RESULTS OF SURVEYS MADE ON THE DATES INDICATED AND CAN ONLY BE CONSIDERED AS INDICATING THE GENERAL CONDITIONS AT THAT TIME.
 SURVEYED BY THE CORPS OF ENGINEERS.
 *SHOALEST SOUNDING PER QUARTER PER REACH

SOUNDINGS WERE TAKEN BY FATHOMETER AND ARE SHOWN TO THE NEAREST TENTH OF A FOOT. SOUNDINGS ARE BASED ON THE DATUM OF MEAN LOWER LOW WATER AT THE LOCALITY. BASE MAPS ARE USDA NAIP 2010.
 PLANE GRID, BEARING AND COORDINATES ARE BASED ON THE STATE OF CALIFORNIA COORDINATE SYSTEM, LAMBERT CONFORMAL PROJECTION, ZONE III, CALIFORNIA, AS DESCRIBED IN SPECIAL PUBLICATION NO. 235, PUBLISHED BY NATIONAL OCEAN SURVEY.
 THE PROJECT DEPTH IS 30 FEET AT M.L.L.W.
 SOUNDINGS ARE BASED ON THE TIDE GAUGE LOCATED AT RAZ 6 & RAZ 5
 LINES 18+00 TO 100+00 @ BEACON NO. 8
 LINES 101+00 TO 160+00 @ RAZ 6
 LINES 160+ TO 208+49 @ RAZ 5
 VERTICAL CONTROL:
 BENCHMARK, MLLW ELEV., AGENCY
 BM 4501 A, NOS TIDAL DISK, 12.15 MLLW
 BM 4508 U 1998, NOS TIDAL DISK, 11.88 MLLW
 BM 13 1974, NOS TIDAL DISK, 12.99 MLLW
 HORIZONTAL CONTROL:
 DESIGNATION, SOURCE, XYZ
 COAST GUARD D-BEACON.

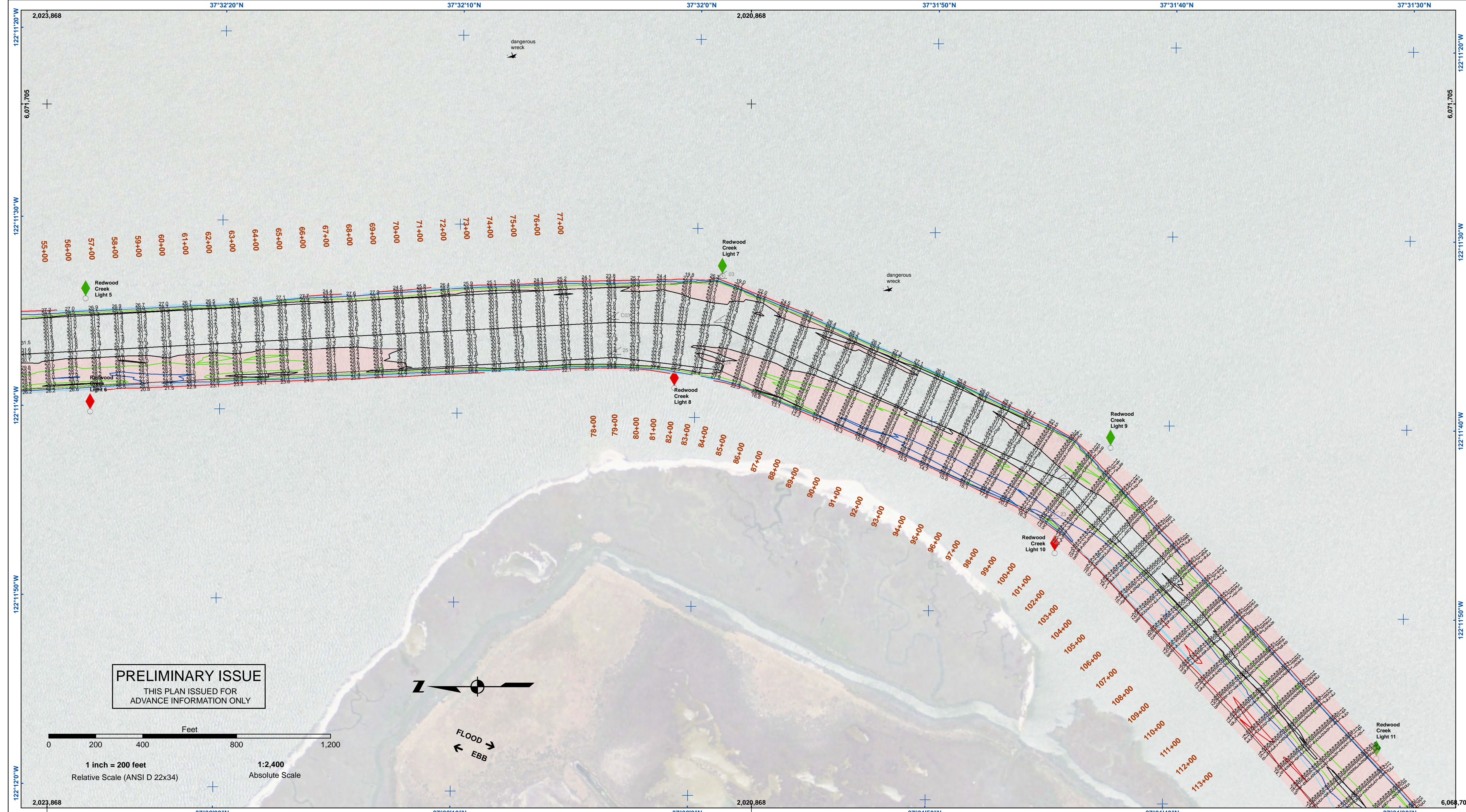

PRELIMINARY ISSUE
THIS PLAN ISSUED FOR
ADVANCE INFORMATION ONLY

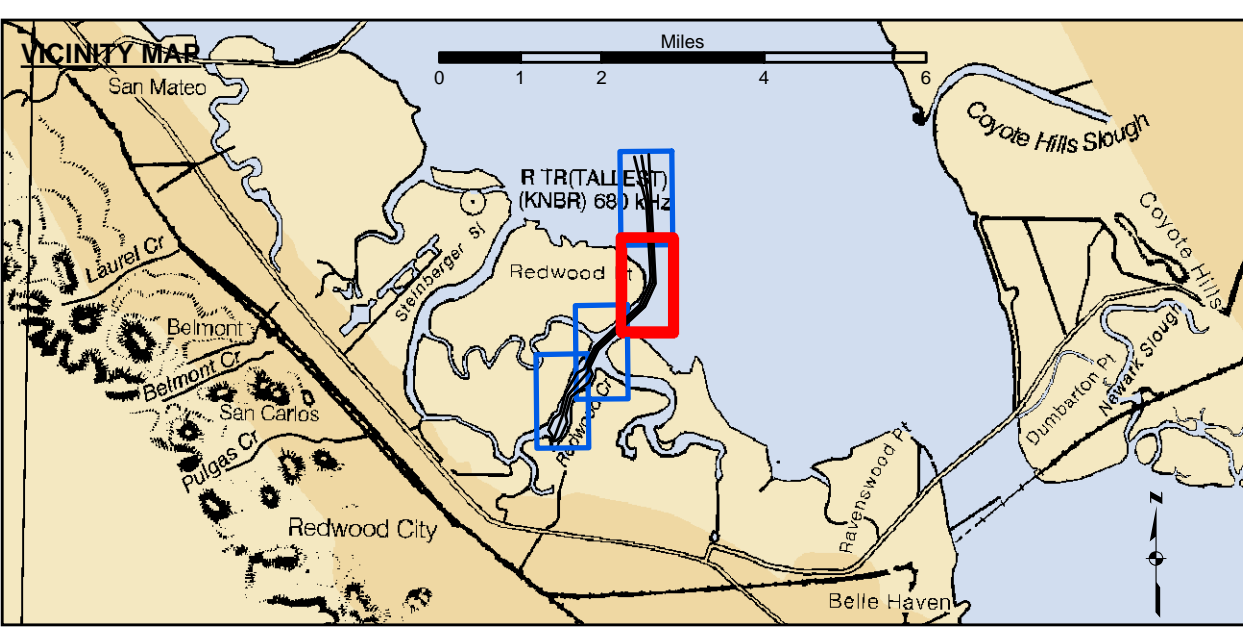
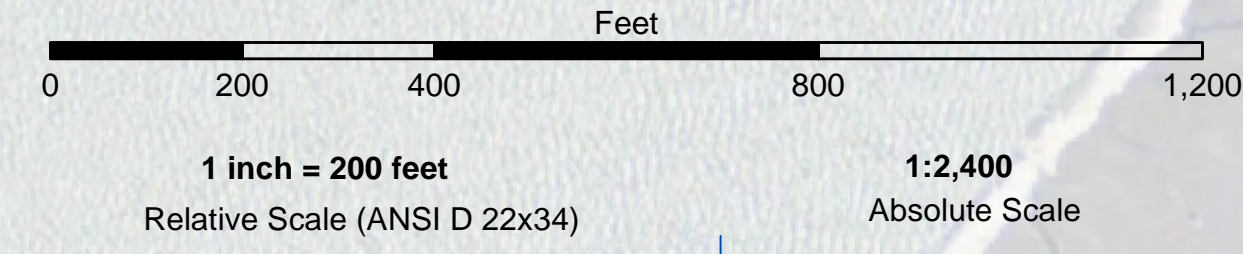

	Federal Navigation Channel		Beacon, General	Contours	
	Shoaling Area		Obstruction Point		
	Material Placement Area		Navigation Buoy		
	Anchorage Area		Navigation Buoy		
	Wreck Area		Shoalest Sounding*		
	Submerged Wreck				-30
	Angle Point				-29
					-28
					-27
					-26

NOTES:
DRAWING NOT TO BE USED FOR NAVIGATION. ONLY CHANNEL CONDITION AT DATE OF SURVEY.
THE LOCATION OF ALL NAVIGATION AIDS ARE BASED ON INFORMATION PROVIDED BY THE U.S. COAST GUARD. BUOY LOCATIONS REPRESENT THE POSITION OF THE SINKER ONLY.
INFORMATION DEPICTED ON THIS MAP REPRESENTS THE RESULTS OF SURVEYS MADE ON THE DATES INDICATED AND CAN ONLY BE CONSIDERED AS INDICATING THE GENERAL CONDITIONS AT THAT TIME.
SURVEYED BY THE CORPS OF ENGINEERS.
*SHOALEST SOUNDING PER QUARTER PER REACH

SOUNDINGS WERE TAKEN BY FATHOMETER AND ARE SHOWN TO THE NEAREST TENTH OF A FOOT. SOUNDINGS ARE BASED ON THE DATUM OF MEAN LOWER LOW WATER AT THE LOCALITY. BASE MAPS ARE USDA NAIP 2010.
PLANE GRID, BEARING AND COORDINATES ARE BASED ON THE STATE OF CALIFORNIA COORDINATE SYSTEM, LAMBERT CONFORMAL PROJECTION, ZONE III, CALIFORNIA, AS DESCRIBED IN SPECIAL PUBLICATION NO. 235, PUBLISHED BY NATIONAL OCEAN SURVEY.
THE PROJECT DEPTH IS 30 FEET AT M.L.L.W.
SOUNDINGS ARE BASED ON THE TIDE GAUGE LOCATED AT RAZ 6 & RAZ 5
LINES 18+00 TO 100+00 @ BEACON NO. 8
LINES 101+00 TO 160+00 @ RAZ 6
LINES 160+ TO 208+49 @ RAZ 5
VERTICAL CONTROL:
BENCHMARK, MLLW ELEV. AGENCY
BM 4501 A, NOS TIDAL DISK, 12.15 MLLW
BM 4508 U 1998, NOS TIDAL DISK, 11.88 MLLW
BM 13 1974, NOS TIDAL DISK, 12.99 MLLW
HORIZONTAL CONTROL:
DESIGNATION, SOURCE, XYZ
COAST GUARD D-BEACON.



DISCLAIMER
The United States Government furnishes this information for general information only. The data represents the results of data collected by the United States Government. The data is not intended for use in any other manner than that intended by the United States Government. The user is responsible for the results of any application of the data for other than its intended purpose. The user is responsible for the results of any application of the data for other than its intended purpose. The user is responsible for the results of any application of the data for other than its intended purpose. The user is responsible for the results of any application of the data for other than its intended purpose.

Chart Date:	Jun 07, 2019
Designed by:	PDT
Plotted by:	PDT
Checked by:	PDT
Drawn by:	PDT

CALIFORNIA
SAN MATEO COUNTY
REWOOD CITY
CONDITION SURVEY
24-28 MAY 2019

Sheet Reference Number
2 of 4

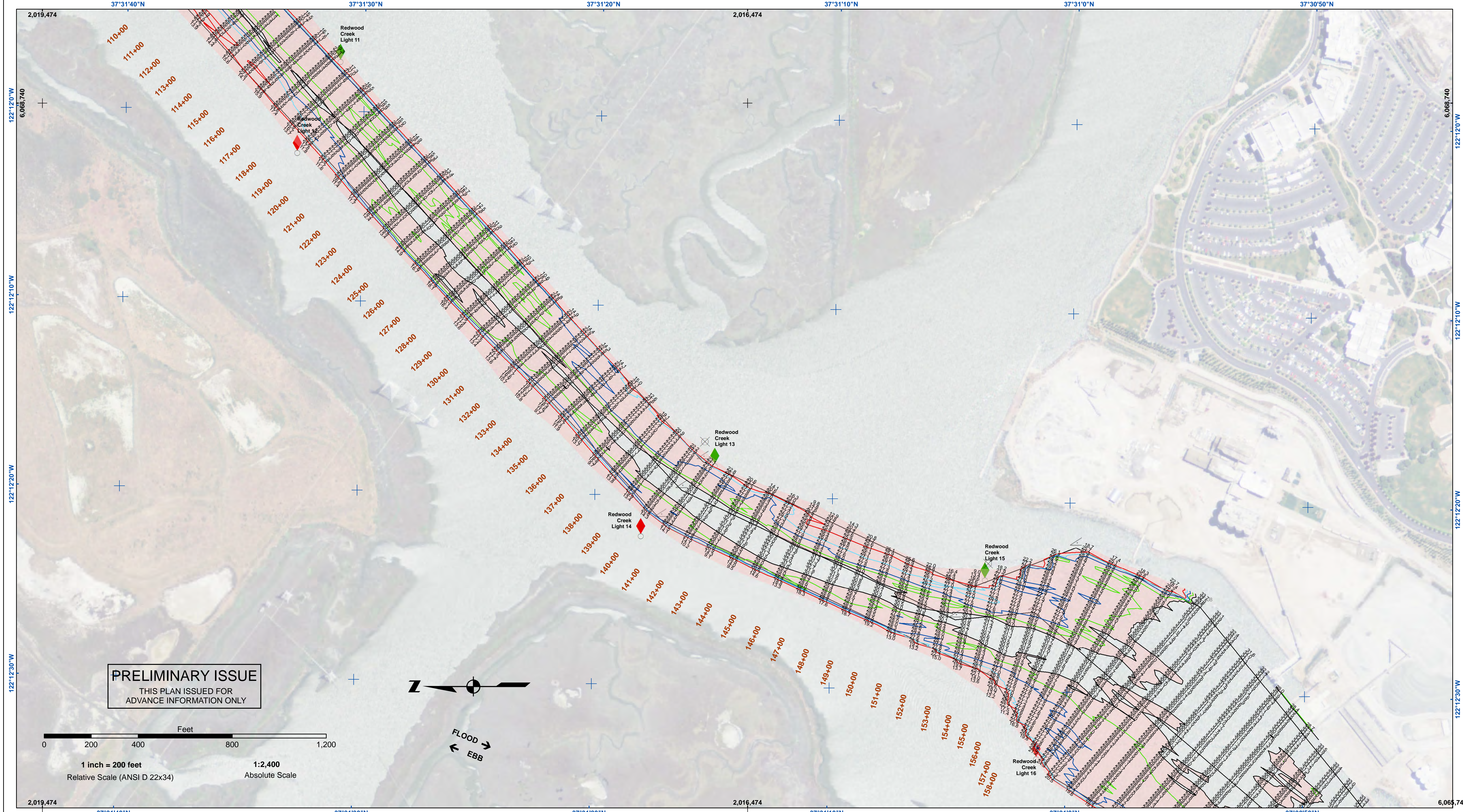

PRELIMINARY ISSUE
THIS PLAN ISSUED FOR
ADVANCE INFORMATION ONLY

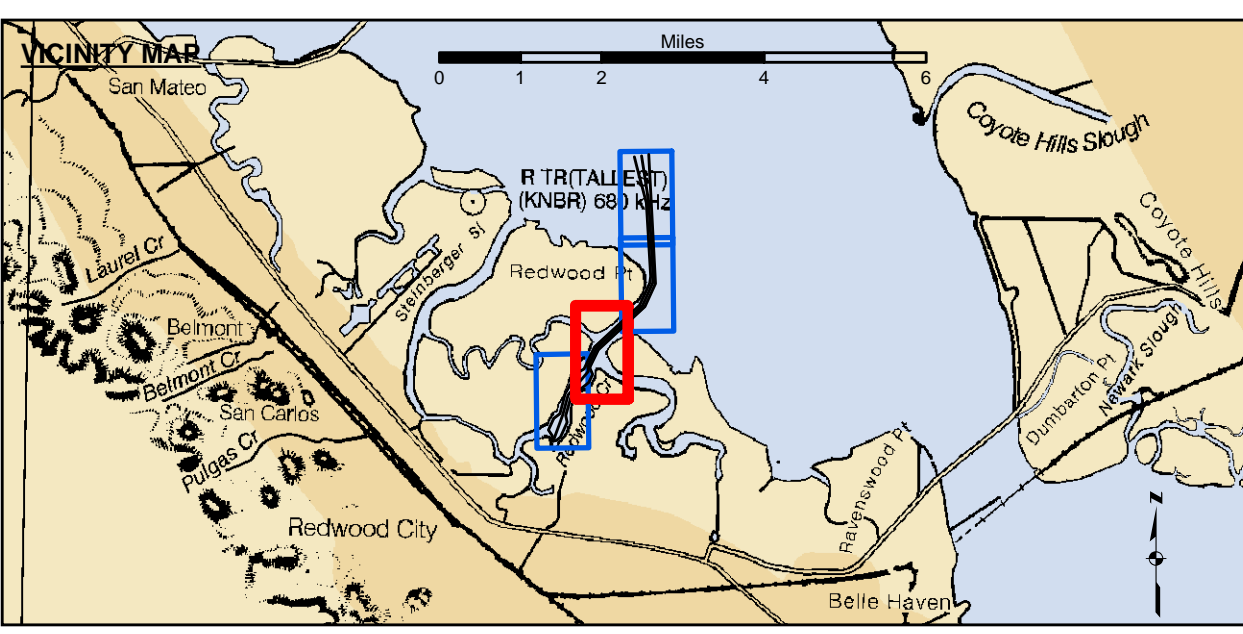
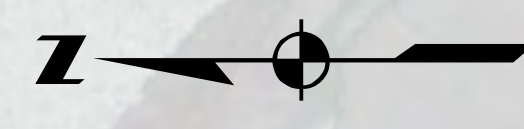

	Federal Navigation Channel		Beacon, General	Contours	
	Shoaling Area		Obstruction Point		
	Material Placement Area		Navigation Buoy		
	Anchorage Area		Navigation Buoy		
	Wreck Area		Shoalest Sounding*		
	Submerged Wreck				-30
	Angle Point				-29
					-28
					-27
					-26

NOTES:
DRAWING NOT TO BE USED FOR NAVIGATION. ONLY CHANNEL CONDITION AT DATE OF SURVEY.
THE LOCATION OF ALL NAVIGATION AIDS ARE BASED ON INFORMATION PROVIDED BY THE U.S. COAST GUARD. BUOY LOCATIONS REPRESENT THE POSITION OF THE SINKER ONLY.
INFORMATION DEPICTED ON THIS MAP REPRESENTS THE RESULTS OF SURVEYS MADE ON THE DATES INDICATED AND CAN ONLY BE CONSIDERED AS INDICATING THE GENERAL CONDITIONS AT THAT TIME.
SURVEYED BY THE CORPS OF ENGINEERS.
*SHOALEST SOUNDING PER QUARTER PER REACH

SOUNDINGS WERE TAKEN BY FATHOMETER AND ARE SHOWN TO THE NEAREST TENTH OF A FOOT. SOUNDINGS ARE BASED ON THE DATUM OF MEAN LOWER LOW WATER AT THE LOCALITY. BASE MAPS ARE USDA NAIP 2010.
PLANE GRID, BEARING AND COORDINATES ARE BASED ON THE STATE OF CALIFORNIA COORDINATE SYSTEM, LAMBERT CONFORMAL PROJECTION, ZONE III, CALIFORNIA, AS DESCRIBED IN SPECIAL PUBLICATION NO. 235, PUBLISHED BY NATIONAL OCEAN SURVEY.
THE PROJECT DEPTH IS 30 FEET AT M.L.L.W.
SOUNDINGS ARE BASED ON THE TIDE GAUGE LOCATED AT RAZ 6 & RAZ 5
LINES 18+00 TO 100+00 @ BEACON NO. 8
LINES 101+00 TO 160+00 @ RAZ 6
LINES 160+ TO 208+49 @ RAZ 5
VERTICAL CONTROL:
BENCHMARK, MLLW ELEV., AGENCY
BM 4501 A, NOS TIDAL DISK, 12.15 MLLW
BM 4508 U 1998, NOS TIDAL DISK, 11.88 MLLW
BM 13 1974, NOS TIDAL DISK, 12.99 MLLW
HORIZONTAL CONTROL:
DESIGNATION, SOURCE, XYZ
COAST GUARD D-BEACON.

DISCLAIMER: The United States Government furnishes this information for general information only. The United States Government makes no warranty, expressed or implied, concerning the accuracy, completeness, reliability, usability, or timeliness of the information. The user is responsible for the results of any application of the information. The user is responsible for the results of any application of the information. The user is responsible for the results of any application of the information. The user is responsible for the results of any application of the information.

Prepared Under the Direction of	JOHN C. MORROW	Chart Date:	Jun 07, 2019
LT Colonel, C.E., District Engineer		Designed by:	
Subject:	Hydro Survey Team Leader	Plotted by:	PDT
Recommended by:	Chief, Hydro Survey Section	Checked by:	PDT
Approved:	Chief, Construction Branch	Drawn by:	PDT

SAN MATEO COUNTY
REWOOD CITY
CONDITION SURVEY
24-28 MAY 2019

Sheet Reference Number
3 of 4

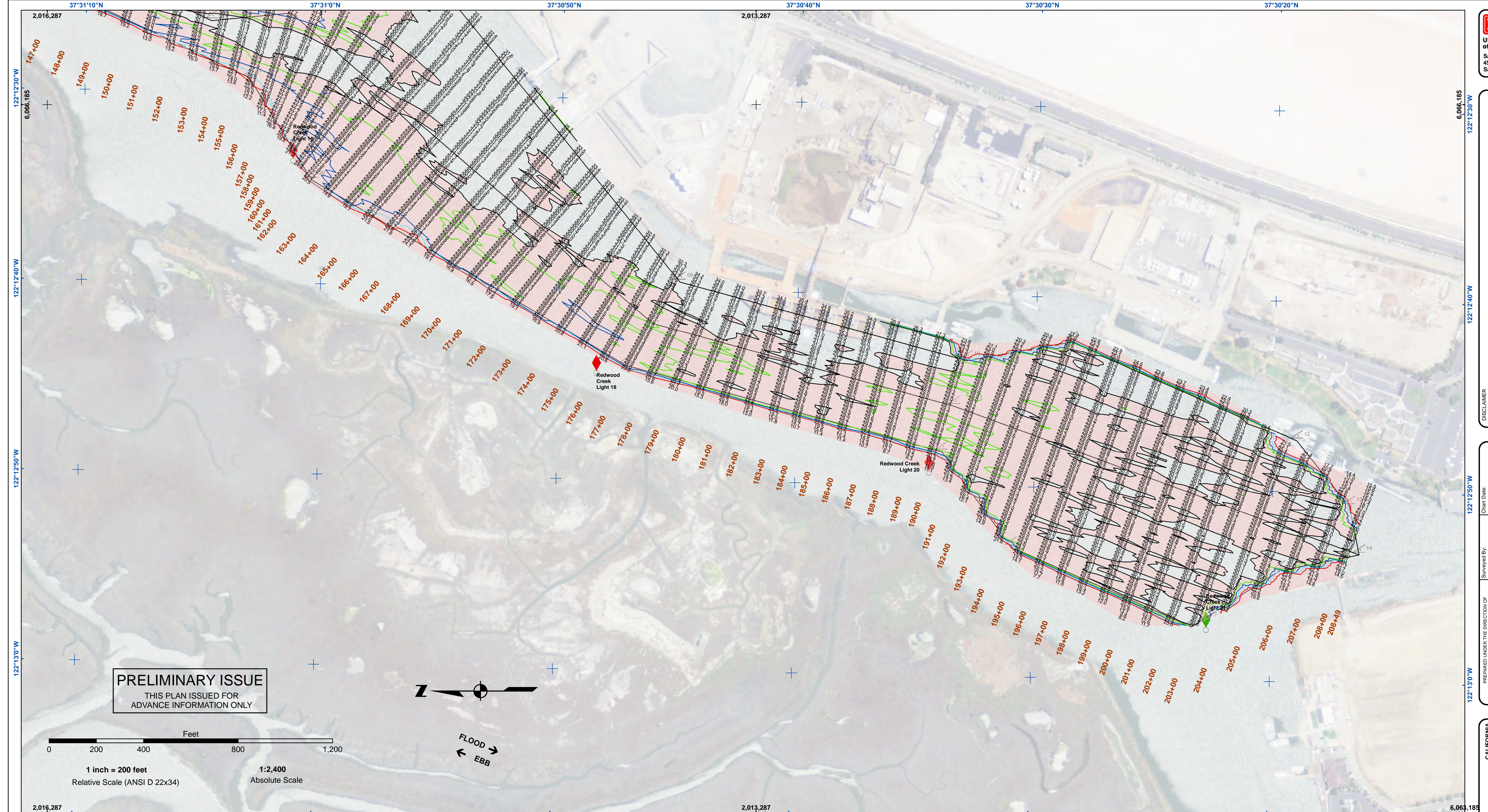

PRELIMINARY ISSUE
THIS PLAN ISSUED FOR
ADVANCE INFORMATION ONLY

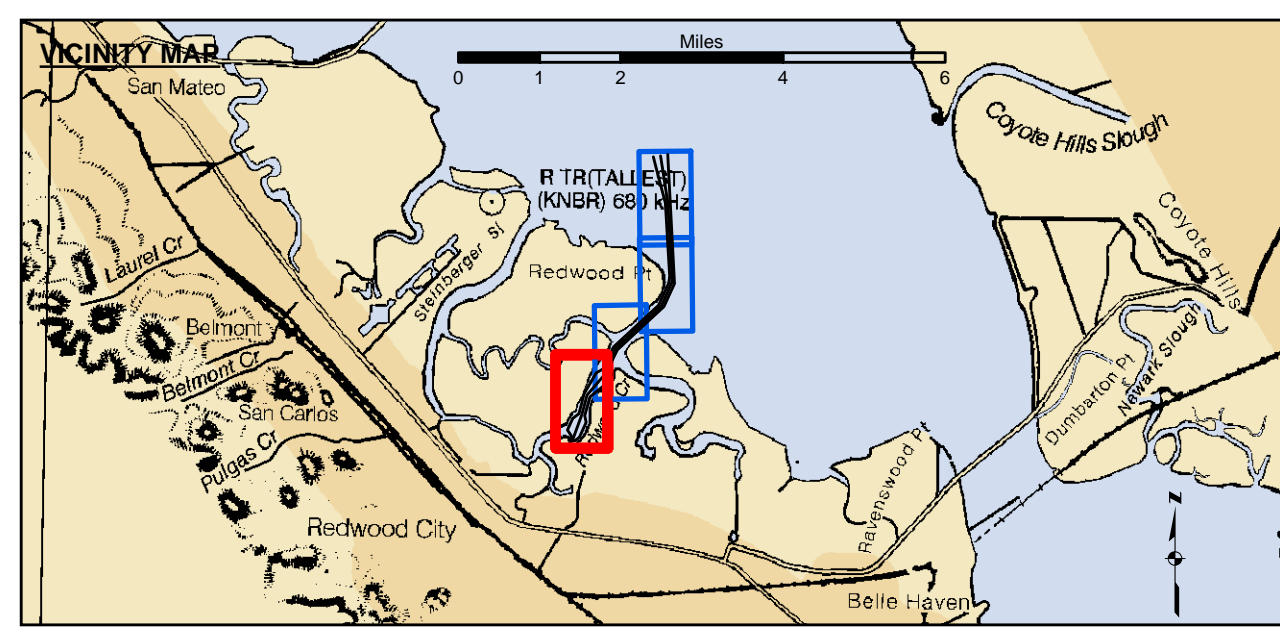

	Federal Navigation Channel		Beacon, General	Contours	
	Shoaling Area		Obstruction Point		
	Material Placement Area		Navigation Buoy		
	Anchorage Area		Navigation Buoy		
	Wreck Area		Shoalest Sounding*		
	Submerged Wreck				-30
	Angle Point				-29
					-28
					-27
					-26

NOTES:
DRAWING NOT TO BE USED FOR NAVIGATION. ONLY CHANNEL CONDITION AT DATE OF SURVEY.
SOUNDINGS ARE BASED ON THE DATUM OF MEAN LOWER LOW WATER AT THE LOCALITY.
THE LOCATION OF ALL NAVIGATION AIDS ARE BASED ON INFORMATION PROVIDED BY THE U.S. COAST GUARD. BUOY LOCATIONS REPRESENT THE POSITION OF THE SINKER ONLY.
INFORMATION DEPICTED ON THIS MAP REPRESENTS THE RESULTS OF SURVEYS MADE ON THE DATES INDICATED AND CAN ONLY BE CONSIDERED AS INDICATING THE GENERAL CONDITIONS AT THAT TIME.
SURVEYED BY THE CORPS OF ENGINEERS.
*SHOALEST SOUNDING PER QUARTER PER REACH

SOUNDINGS WERE TAKEN BY FATHOMETER AND ARE SHOWN TO THE NEAREST TENTH OF A FOOT.
SOUNDINGS ARE BASED ON THE DATUM OF MEAN LOWER LOW WATER AT THE LOCALITY.
BASE MAPS ARE USDA NAIP 2010.
PLANE GRID, BEARING AND COORDINATES ARE BASED ON THE STATE OF CALIFORNIA COORDINATE SYSTEM, LAMBERT CONFORMAL PROJECTION, ZONE III, CALIFORNIA, AS DESCRIBED IN SPECIAL PUBLICATION NO. 235, PUBLISHED BY NATIONAL OCEAN SURVEY.
THE PROJECT DEPTH IS 30 FEET AT M.L.L.W.
SOUNDINGS ARE BASED ON THE TIDE GAUGE LOCATED AT RAZ 6 & RAZ 5
LINES 18+00 TO 100+00 @ BEACON NO. 8
LINES 101+00 TO 160+00 @ RAZ 6
LINES 160+ TO 208+49 @ RAZ 5
VERTICAL CONTROL:
BENCHMARK, MLLW ELEV., AGENCY
BM 4501 A, NOS TIDAL DISK, 12.15 MLLW
BM 4508 U 1998, NOS TIDAL DISK, 11.88 MLLW
BM 13 1974, NOS TIDAL DISK, 12.99 MLLW
HORIZONTAL CONTROL:
DESIGNATION, SOURCE, XYZ
COAST GUARD D-BEACON.

US Army Corps of Engineers
San Francisco District
450 Golden Gate Ave
San Francisco, CA 94102

DISCLAIMER
The United States Government furnishes this information as a service to the public and does not warrant, express or implied, the accuracy, completeness, or reliability of the information for any particular purpose. The user is responsible for the results of any application of the data for other than its intended purpose. These data belong to the Government. Therefore, the recipient may not transfer these data to others without also transferring this disclaimer.

Prepared Under the Direction of JOHN C. MORROW LT COLONEL, C.E., DISTRICT ENGINEER	Chart Date: Jun 07, 2019
Submitted: Hydro Survey Team Leader	Designed by: PDT
Recommended: Chief, Hydro Survey Station	Plotted by: PDT
Approved: Chief, Construction Branch	Checked by: PDT
	Drawn by: PDT

SAN MATEO COUNTY
REWOOD CITY
CONDITION SURVEY
24-28 MAY 2019

Sheet Reference Number
4 of 4